

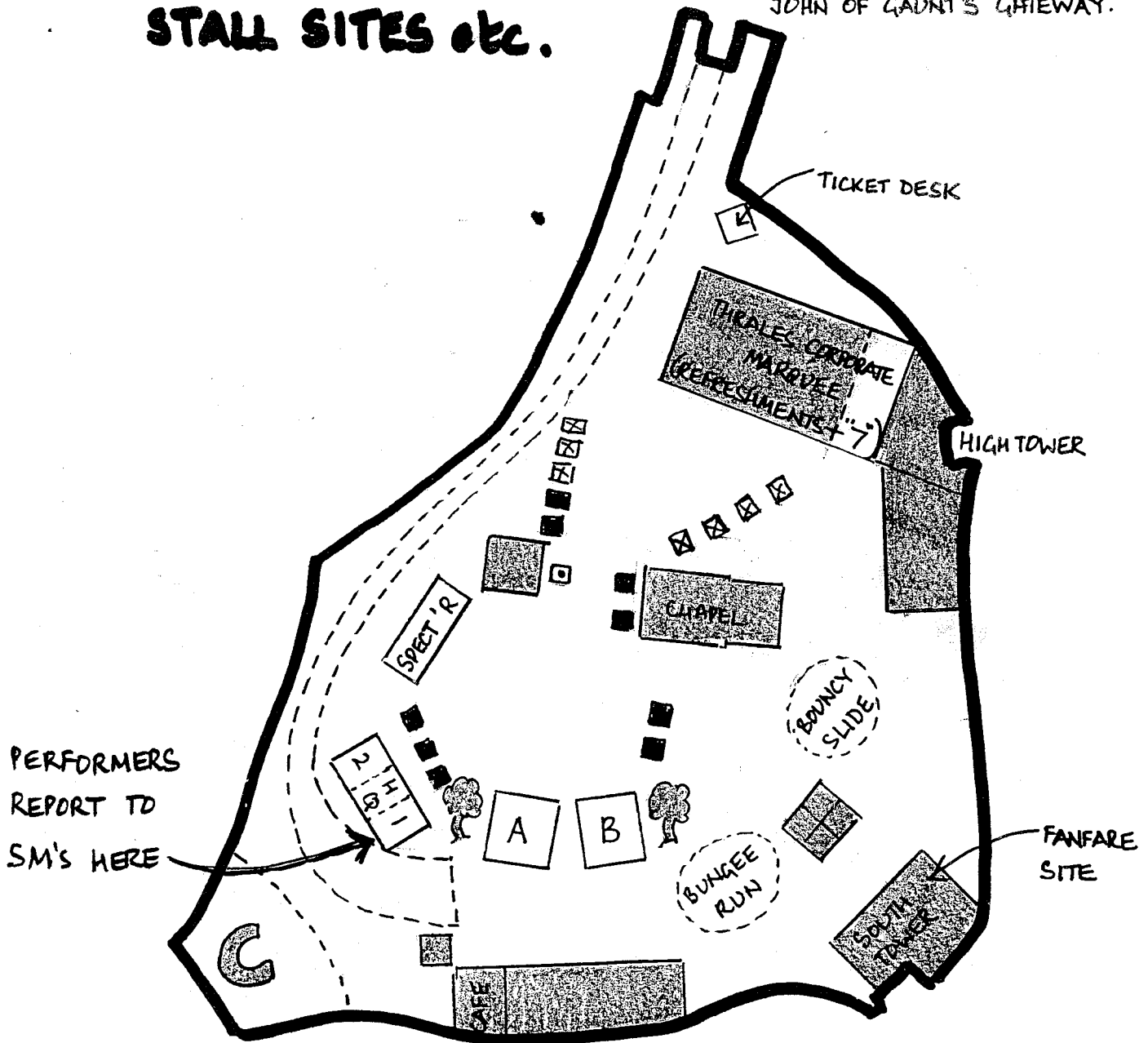

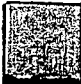

STALL SITES etc.

JOHN OF GAUNT'S GATEWAY.



-  CASTLE STRUCTURES, BUILDINGS and SITES OF EXCAVATION
-  STALLS PROVIDED WITH CAZEBDS BY T.A.G. (inc. W.I.)
-  ALL OTHER STALLS
-  PRIZE DRAW SITE.

- 1 = PERFORMERS' LEFT LUGGAGE/WAITING AREA
- 2 = HELPERS' BASE TENT.

